

CASEMATE

Universal protection
for emergency lighting units
in car-parks and public spaces.



BVCert. 6037554





FEATURES:

- Universal protection for emergency lighting units
- White lacquered steel structure treated against corrosion
- Extra-thick braced crystal polycarbonate diffuser
- Flexible internal reflector
- Suits dimensions of various self-contained lighting units and luminaires with central light source
- Stainless tamper-resistant screws
- RAL 9003 ○

ABAKX	LDE 400 LDE DBR LDE 10 LDE 50 LDE DUAL
ABB (KAUFEL)	BRIO ECO 3 BRIO + BRIO PRIMO 3 PRIMO +
EATON (LUMS-tainless)	LUM16179 LUM16025
LEGRAND	625 25 / 50 / 60 625 26 / 52 (Casemate 120)
URA	110 000 118 218 V / 219 V 111 013 V 113 218 V 112 013 V
ZEMPER	Toledo Xena flat Venus

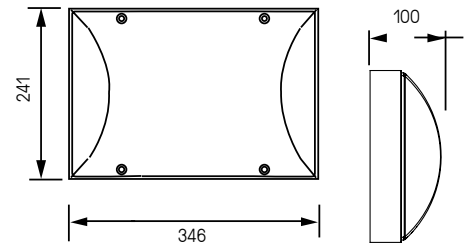

Other models of self-contained and centrally-powered emergency units: please enquire.

All products and names mentioned are trademarks of their respective owners.

Designation	Code
Casemate	9801 0001
Casemate height 120 mm	9801 0002

 Vandal-resistant tool (bit) to be ordered separately
code : 9800 0003

LCIE Test Report no. 19017020
The CASEMATE protector respects the photometric characteristics of the emergency lighting units, in accordance with the requirements of Article 22.16 of the NF EN 60598-2-22 standard from July 1992.

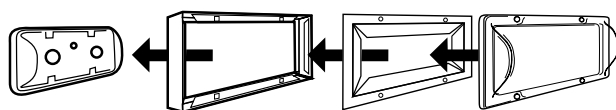

Existing emergency lighting unit on wall

The Casemate's rear opening allows it to be installed directly over the emergency lighting unit without needing to remove it!

Flexible reflector and extra-thick polycarbonate diffuser

 The Casemate protects existing emergency lighting units on the market

 DETAILS



